

Inner Plate Long  
make 2 .1875 thick

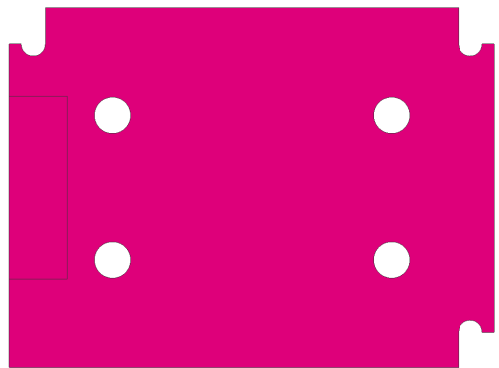

P60 Mount  
Make 2 .1875 thick  
Pocket .125 deep

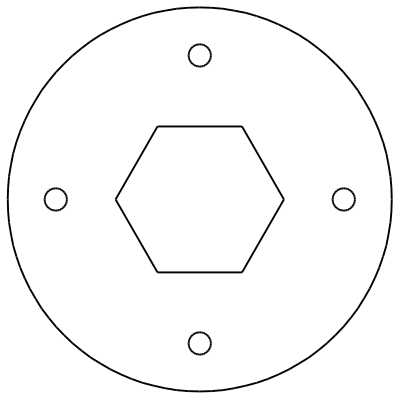

Nut Trap .5in  
make 2 .1875 thick



Shell Support  
make 4 .1875 thick

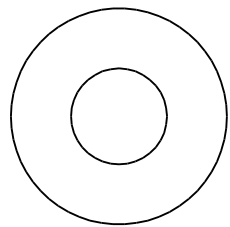

Leg Spacer  
make 8 .125 thick

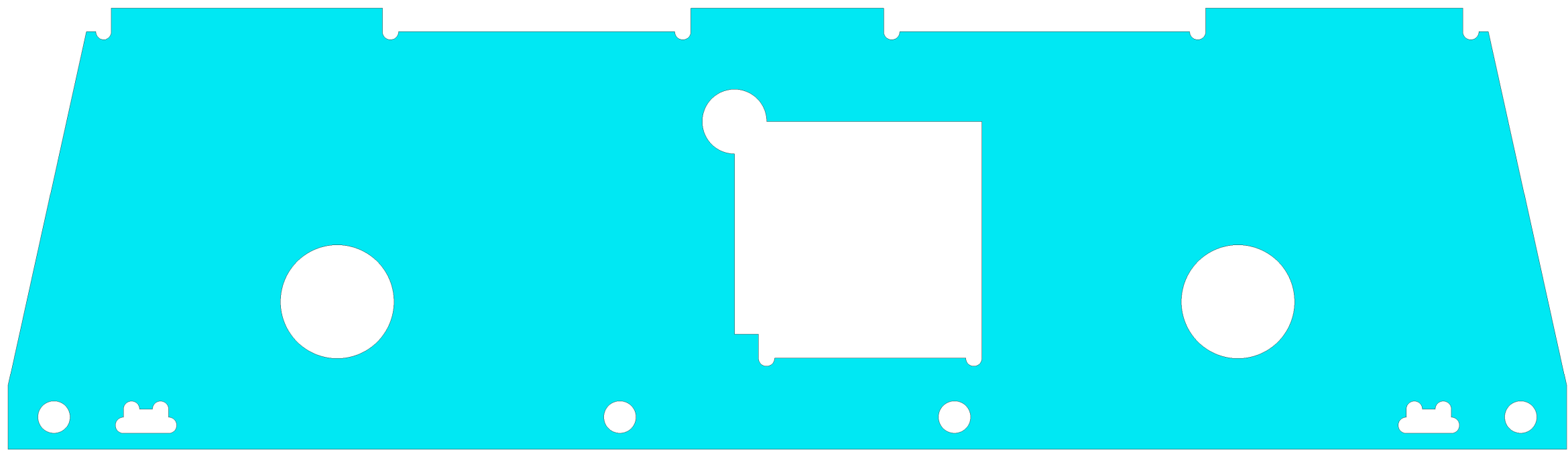

Motor Plate  
Make 2 .1875 thick

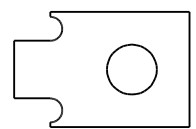

Wheel Anchor  
make 8 .1875 thick

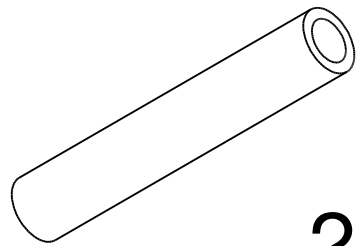

.25 ID tubing/spacer  
2.15 in long - make 4



Center Cross  
Make 2 .1875 thick

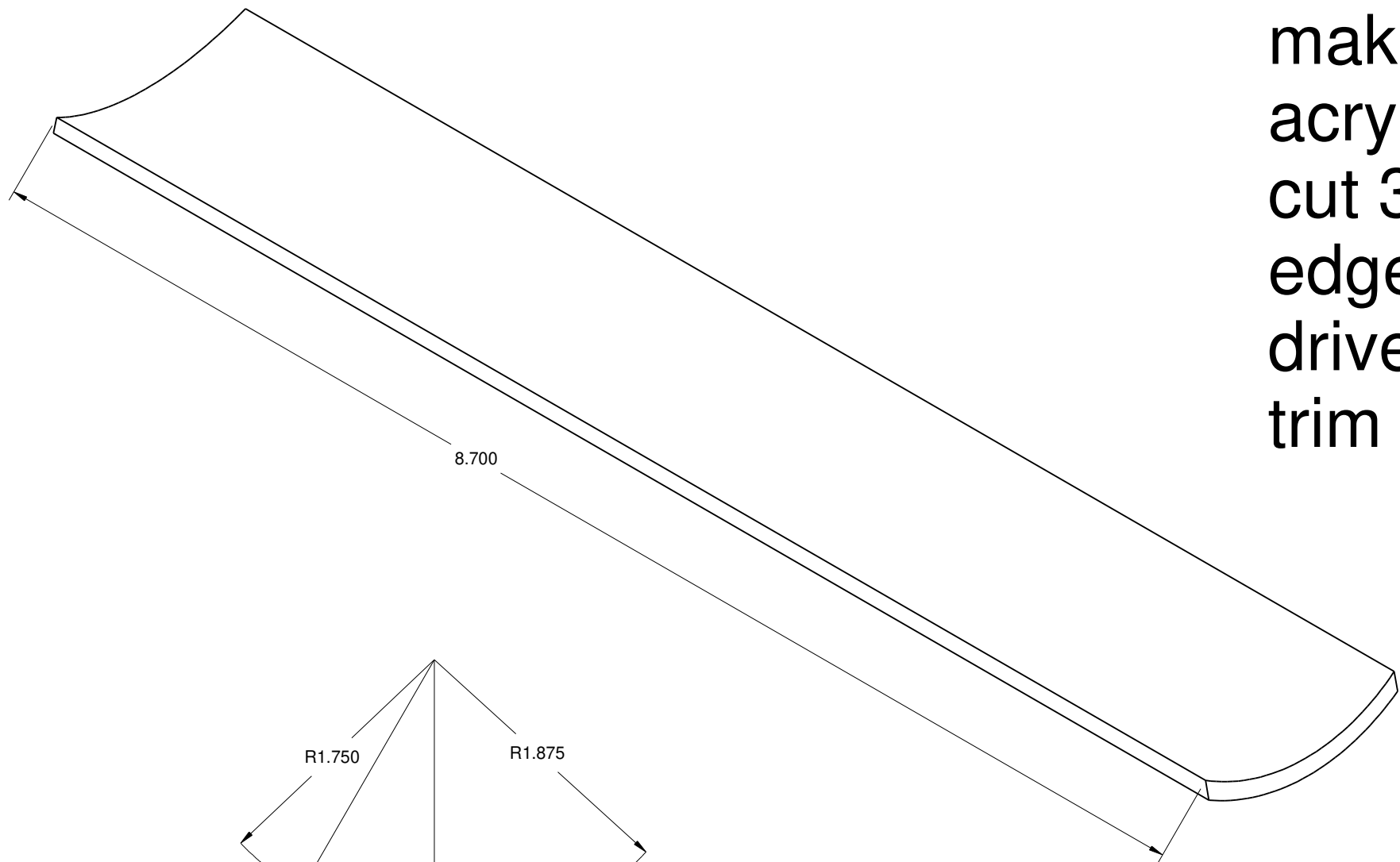

Trench  
make 2 from 3.75 in OD  
acrylic tube 11in long (oversize)  
cut 30 degree section trim  
edges to be vertical. glue into  
drive structural assembly then  
trim ends to match taper of foot.

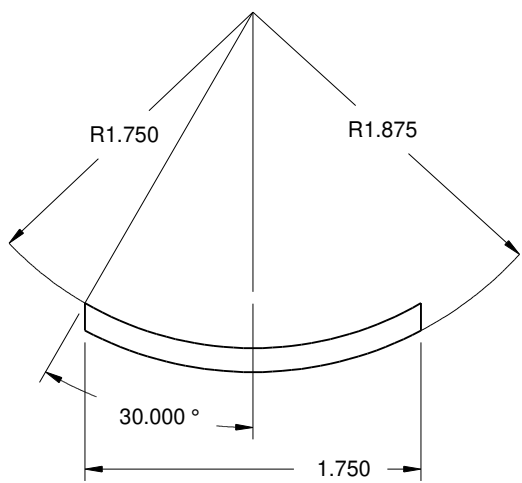

Trench Cross section

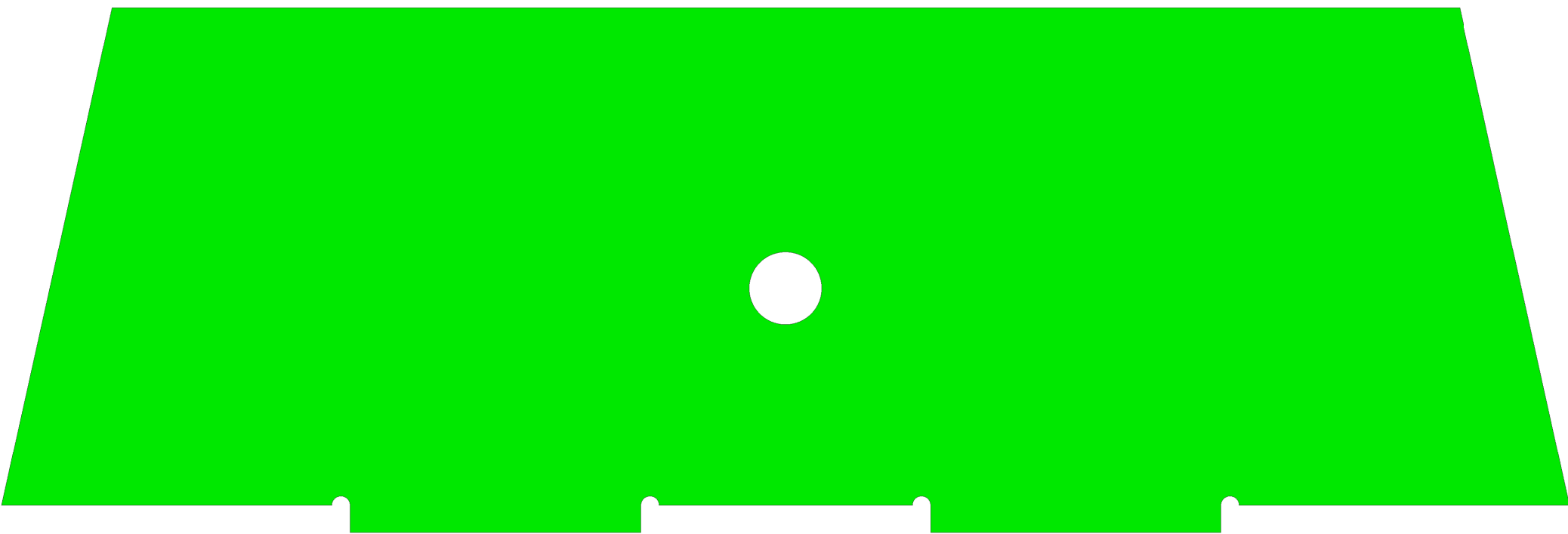

Inner Plate Short  
Make 2 .1875 thick

1" x 1"  
square

## Chopper Foot Drive Structural Version 4.0

Copyright Media-Conversions - Released for non-commercial use ONLY!

DRAWN	DATE 09/16/18			
CHECKED				
QA				
MFG		SIZE C	FSCM NO.	DWG NO. Sheet 1 of 3
APPROVED		SCALE		REV



Shell left end  
make 2 .125 thick  
bevel edges 45 degrees

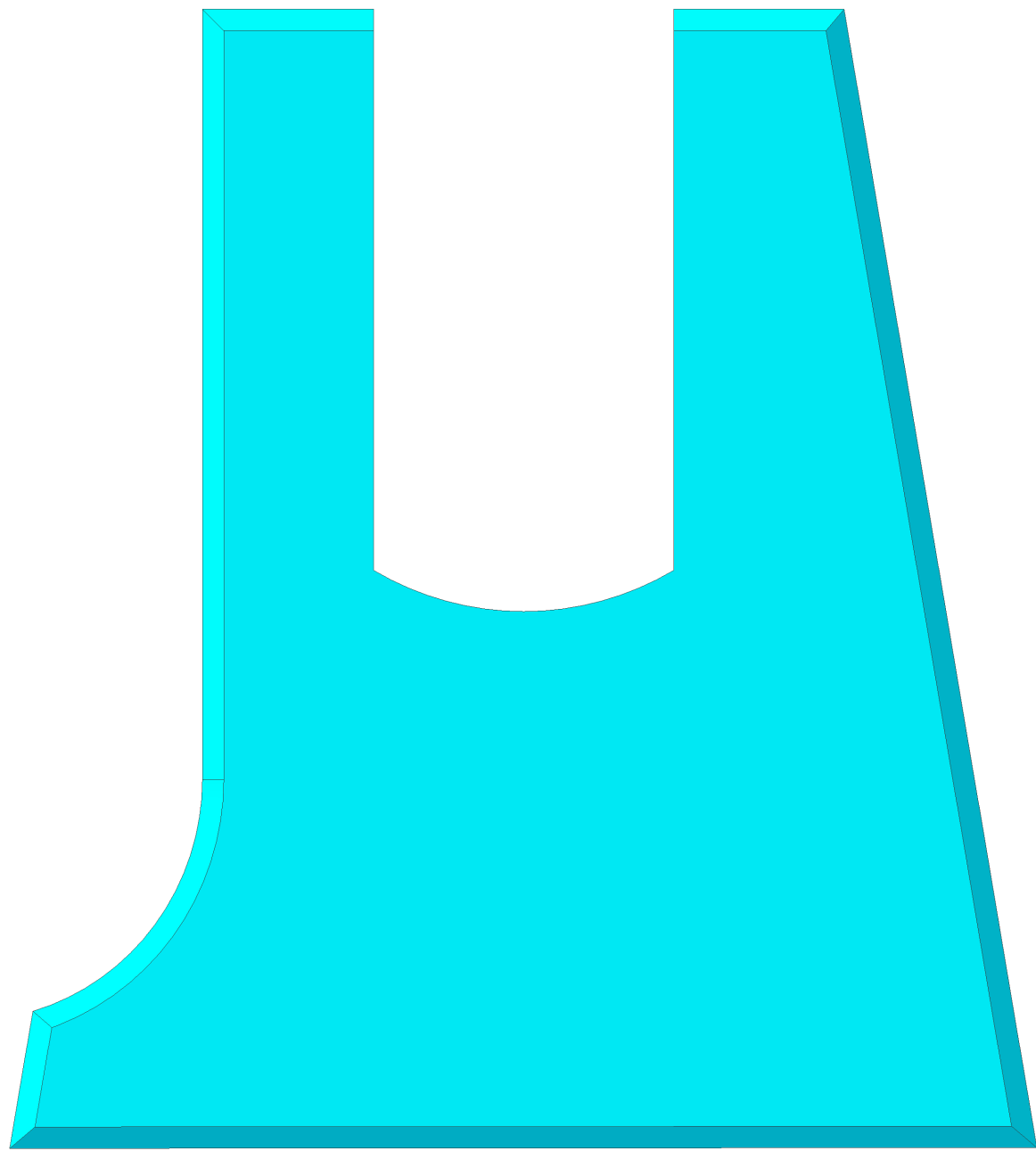

Shell right end  
make 2 .125 thick  
bevel edges 45 degrees



Shell large side  
make 2 .125 thick  
bevel edges 45 degrees

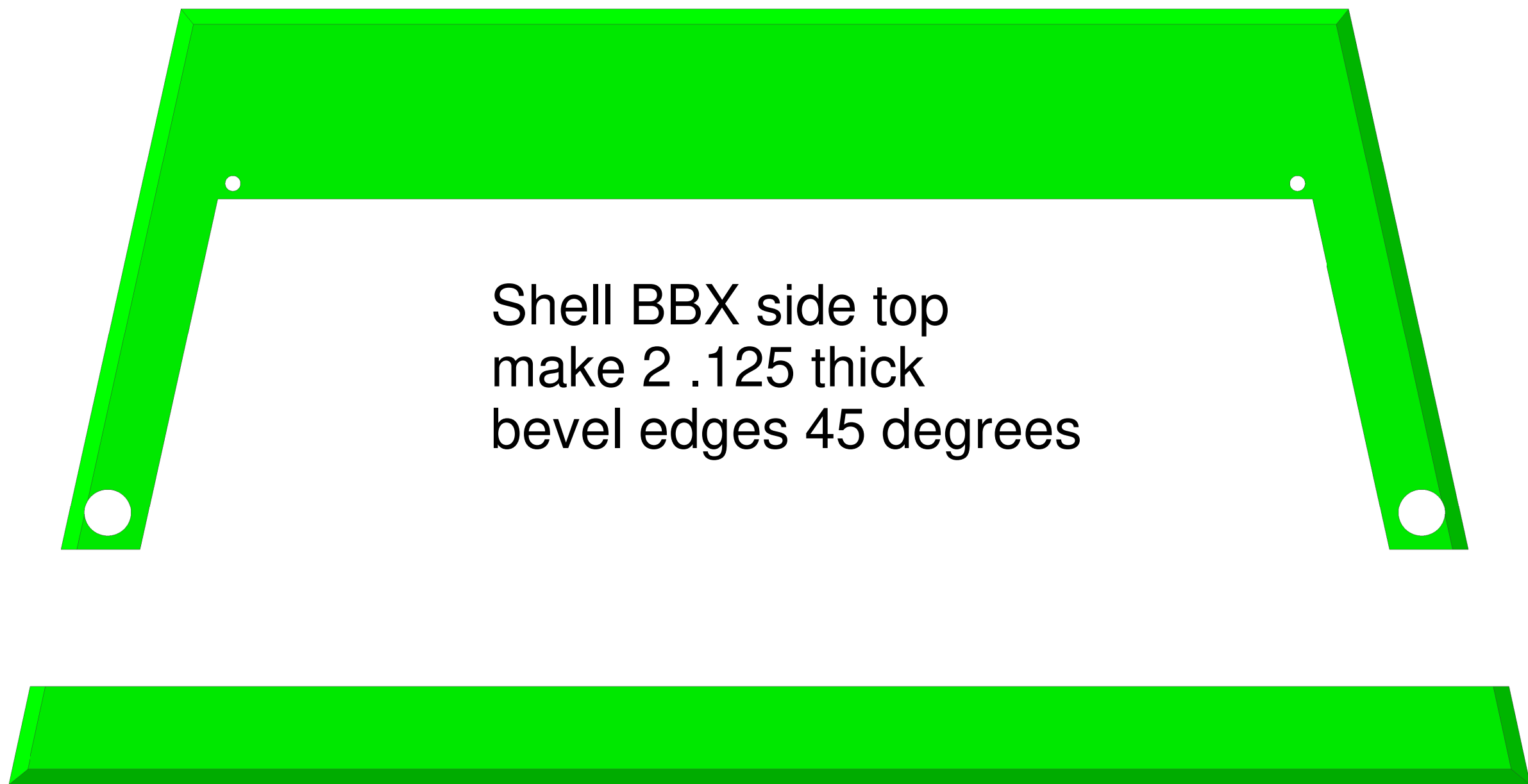

Shell BBX side top  
make 2 .125 thick  
bevel edges 45 degrees



Shell BBX side bot  
make 2 .125 thick  
bevel edges 45 degrees



Shell top BBX side  
Make 2 .125 thick  
bevel edges 45 degrees

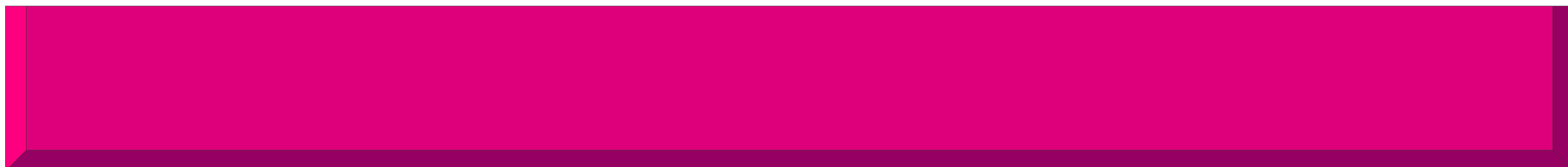

Shell top large side  
make 2 .125 thick  
bevel edges 45 degrees

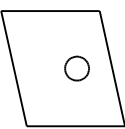
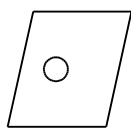

Magnet Backing left & right  
make 2 each .125 thick

1" x 1"  
square

Chopper Foot Drive  
Shell Version 4.0

Copyright Media-Conversions - Released for non-commercial use ONLY!

DRAWN	DATE 09/16/18			
CHECKED				
QA				
MFG		SIZE C	FSOM NO.	DWG NO. sheet 2 of 3
APPROVED		SCALE		REV
				SHEET

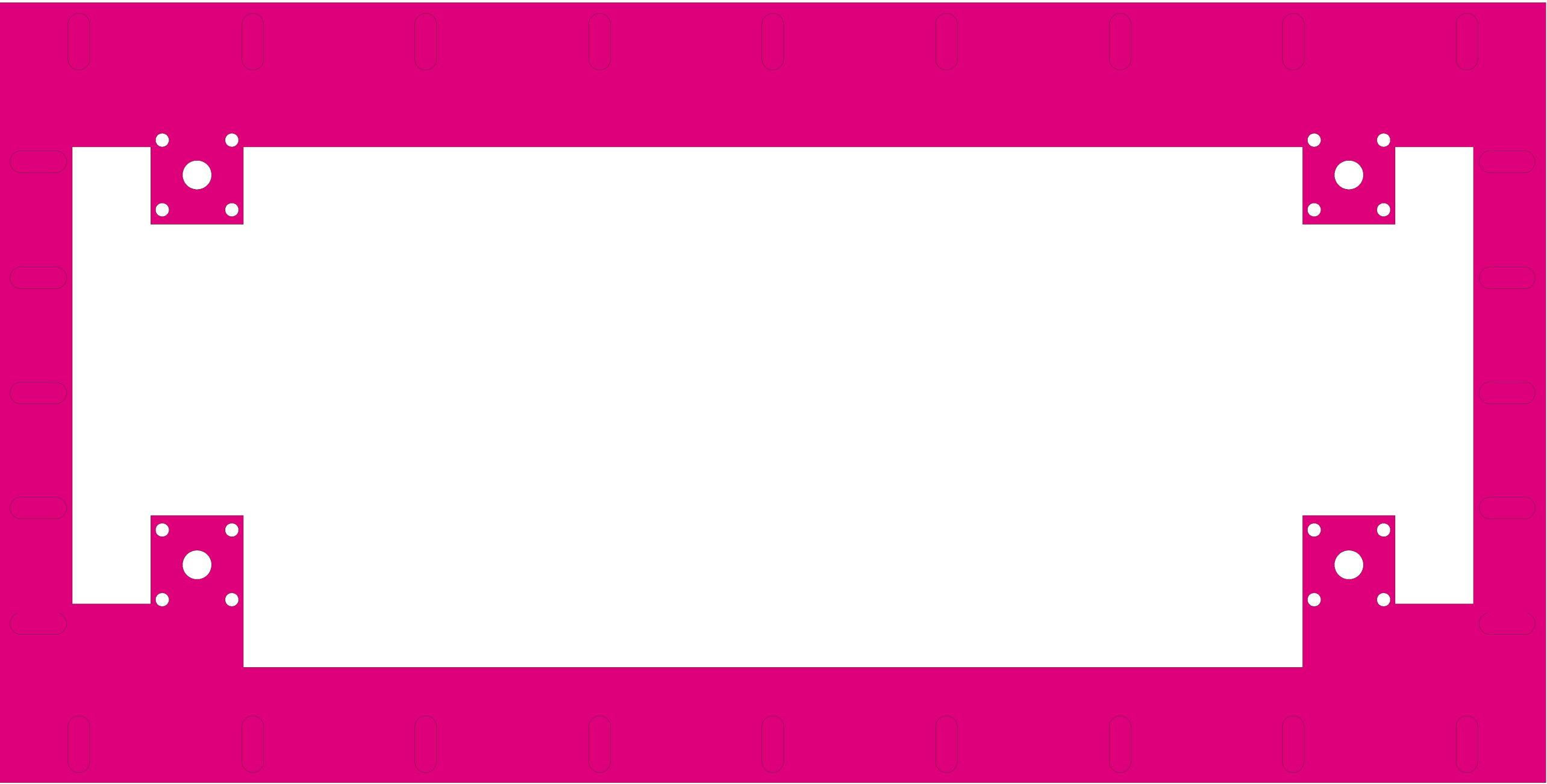

Foot Apron Top  
Make 2 .1875 thick  
oval pockets .125 deep

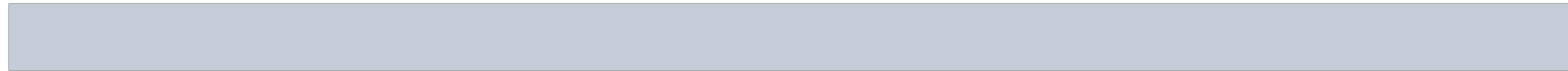

Foot Apron side edge  
Make 4 .1875 thick

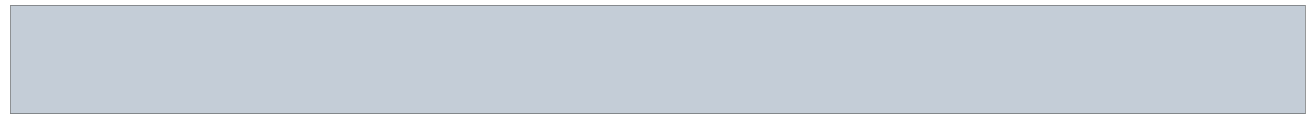

Foot Apron Front & Rear edge  
Make 4 .1875 thick

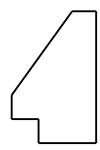

Foot Apron Edge Brace  
make 28 .1875 thick

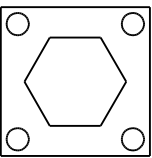

Foot Apron .25 Nut trap  
make 8 .1875 thick

1" x 1"  
square

Chopper Foot Drive  
Apron Version 4.0

Copyright Media-Conversions - Released for non-commercial use ONLY!

DRAWN	DATE	<div>MediaConversions</div>		
CHECKED	09/16/18			
QA				
MFG				
APPROVED		SIZE	FSCM NO.	REV
		C	DWG NO.	
			sheet 3 of 3	
		SCALE		SHEET